

QWD-10

WR-10, 75~110GHz

Features:

- * Broadband
- * High Sensitivity

Applications:

- * Telecom
- * Instrumentation
- * Laboratory Test
- * Radar

Electrical

Frequency Range:	75~110GHz
Sensitivity:	0.1mV/uW min
Flatness:	±2.2dB max.
Polarity:	Negative
Input Power Without Damage:	20dBm

Mechanical

Length:	26.5*32.2mm 1.043*1.276in
Input Connector:	WR-10
Output Connector:	SMA Female

Environmental

Operating Temperature:	-20~+70°C
Non-operating Temperature:	-40~+85°C

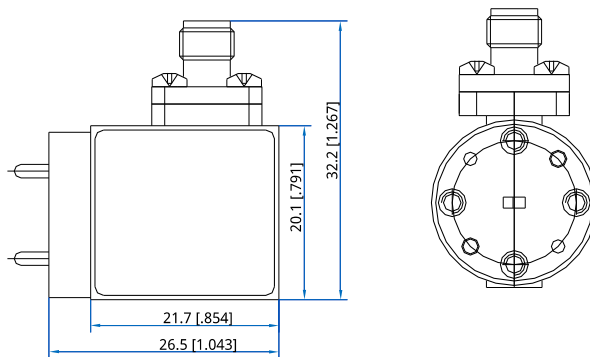
Outline Drawings

Unit: mm [in]

Tolerance: ±0.2mm [±0.008in]

How To Order
QWD-10

Customization is available upon request.